



Church Road Stanmore £650,000

A large, two bedroom, two bathroom flat available chain free in an excellent Central Stanmore location.

On the second floor of a modern building (with a lift) on Church Road, Stanmore close to all the shops, cafes and amenities of Stanmore Broadway as well as the local transport links including Stanmore tube station.

The flat has a large, eat-in kitchen, as well as a separate reception/dining room with dual aspect and access to a large private balcony. The master bedroom is extremely spacious with a walk-in wardrobe, dressing area and en suite bathroom. There is a further double bedroom, family bathroom and lots of built-in storage.

The property benefits from communal gardens and secure underground parking for multiple cars.

Leasehold with approximately 102 years remaining.

Ground rent of £250 per annum.

Service charge (including reserve fund contributions) of £3445.72 per annum.

Harrow Council Tax Band E.

- Two bedrooms
- Two bathrooms
- Private balcony
- Underground parking
- Second floor with lift
- Leasehold

Viewing

Please contact our Davidson Frost-Wellings Office on 020 8954 8806 if you wish to arrange a viewing appointment for this property or require further information.



Floor Plan

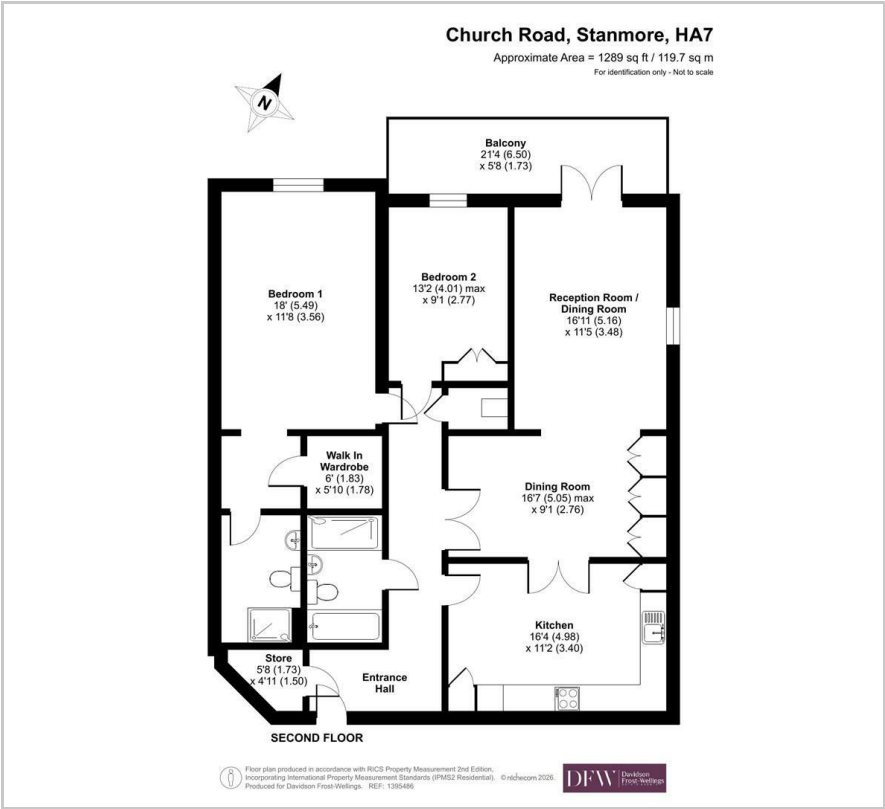

Area Map

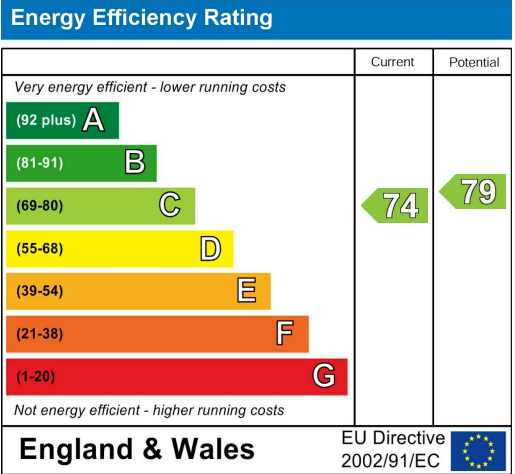

These particulars, whilst believed to be accurate are set out as a general outline only for guidance and do not constitute any part of an offer or contract. Intending purchasers should not rely on them as statements of representation of fact, but must satisfy themselves by inspection or otherwise as to their accuracy. No person in this firms employment has the authority to make or give any representation or warranty in respect of the property.